





-: CONSULTANTS :-		-: CLIENT :-		DRG. NO. :	DESIGNED BY.	APPROVED BY.	-: PROJECT TITLE :-	-:PLAN & PROFILE:-
M/s Lion Engineering Consultants, Bhopal .  RṛqṽP qṭ 9."ṭNkp"Vqy grṭ."Grgi cpṽGuvṽg. Near Mother Teresa School, Kolar Road, Bhopal (M.P.)		 NATIONAL HIGHWAYS INFRASTRUCTURE DEVELOPMENT CORPORATION LIMITED (NHIDCL)		1			Consultancy Services for Preparation of Feasibility Study and Detailed Project Report For Two lane With Paved Shoulders of Manu - Simlung Section of NH-44A (86 Kms) In The State of Tripura on EPC Mode.	FROM DES. CH 66+845 - 67+400 PACKAGE-4 VAGHMUN - SIMLUNG SECTION OF NH-44A



MC00 LEVELS	600.130	601.511	602.835	604.033	605.103	606.046	606.861	607.550	608.112	608.546	608.853	609.034	609.087	609.013	608.811	608.483	608.028	607.445	606.735	605.898	604.935	603.843	602.683	601.522	600.361	599.200	598.039	596.878	595.717	594.556	593.395	592.234	591.073	589.912	588.751	587.590	586.429	585.269	584.108	582.947	581.786	
LZ00 LEVELS	604.195	604.964	605.041	605.305	606.653	608.791	610.398	610.992	611.789	613.427	615.169	618.089	620.555	622.482	624.149	624.711	624.367	623.055	621.213	618.848	616.075	605.742	602.542	602.153	600.426	600.590	599.162	589.820	591.066	588.234	591.089	590.490	590.147	589.339	591.598	589.167	588.479	585.667	583.362	580.716	580.275	
Horizontal																																										
Vertical																																										
Superelevation																																										

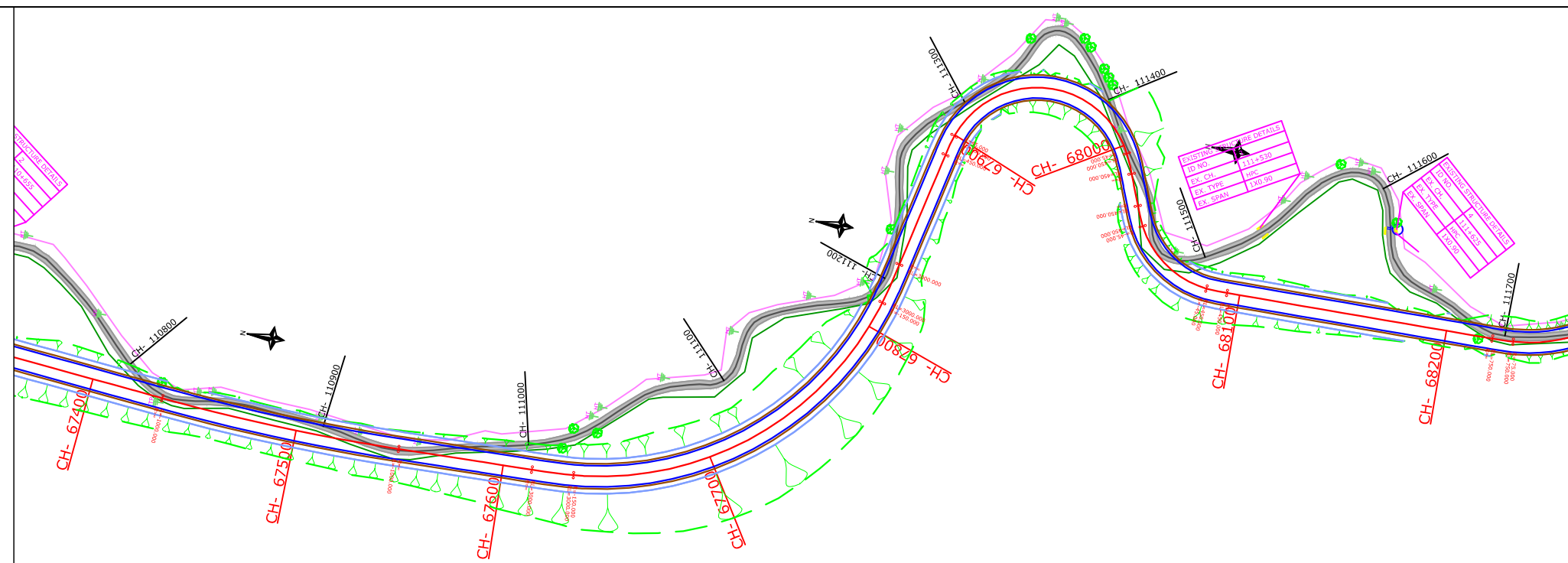

Legend	
Building	
Govt. Building	
Shop Gate	
Hut	
Forest pillar	
Water Tank	
Well	
Temple	 
TBM.	
Electric Pole	
Telephone Pole	
Ht line 11 & 33 kva	 
Nala	
Drain	
Sing Bord	
RYL SP	
Tree Gamla	
Bambu	
Culvert	
Bridge	
Pond	
Handpump	
Tranformer	
Traverse	
Station	
Ground Level	
OFC Welcome Borad	 
River Canla	
Boundry Wall	
Existing ROW	
Existing BT Center Line	
Existing Road Edge	
Existing Shoulder	
Proposed Center Line	
Proposed CARRIGE WAY	
Proposed Shoulder	
Hms	 
Kms RB	 
IL BL	 
TOWER	
PETROL PUMP	
L T Crossing	
H T Crossing	
Public Tap	

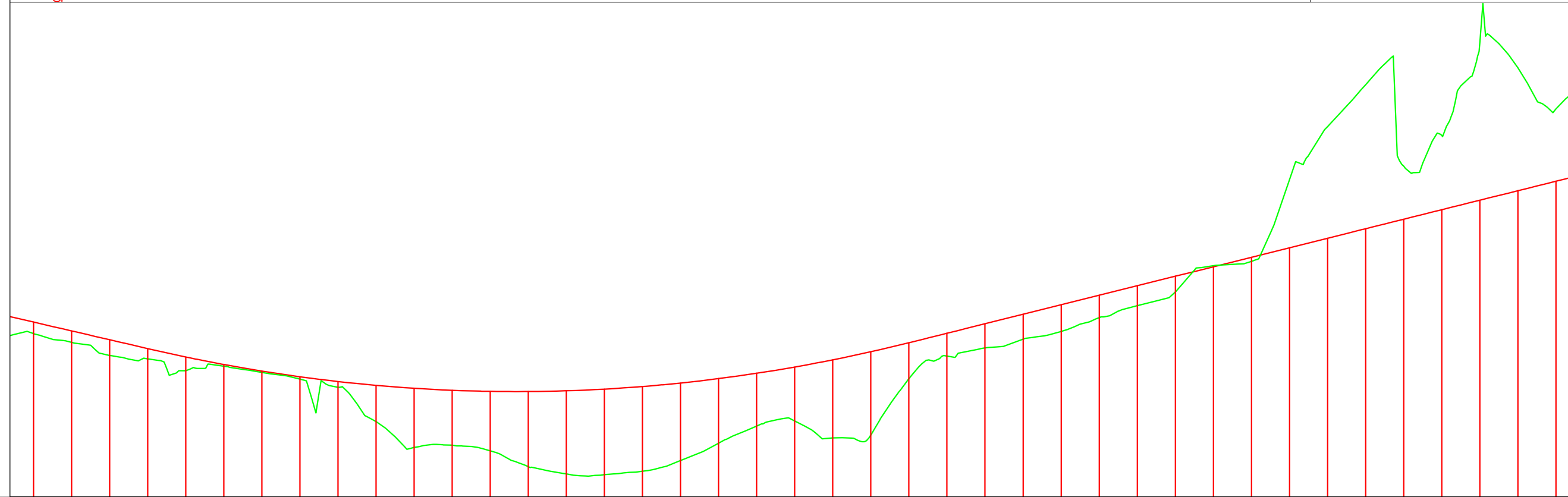
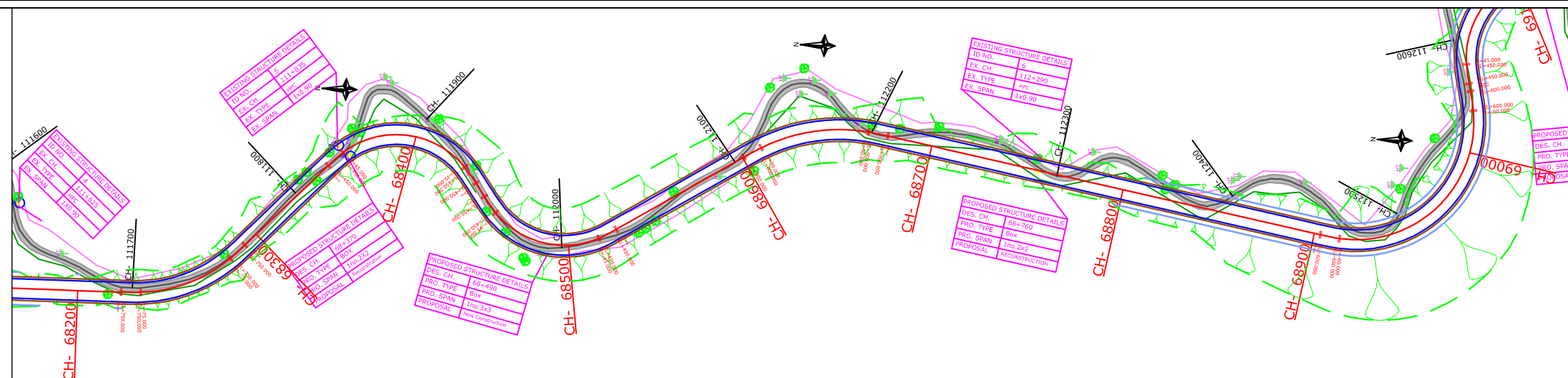
-: CONSULTANTS :-	-: CLIENT :-	DRG. NO. :	DESIGNED BY.	APPROVED BY.	-: PROJECT TITLE :-	-:PLAN & PROFILE:-
M/s Lion Engineering Consultants, Bhopal .  Rtqv'P qQ 9."öNkqp"Vqy gtö."Grqi cpvVGucvg. Near Mother Teresa School, Kolar Road, Bhopal (M.P.)	NATIONAL HIGHWAYS INFRASTRUCTURE DEVELOPMENT CORPORATION LIMITED (NHIDCL) 	2			Consultancy Services for Preparation of Feasibility Study and Detailed Project Report For Two lane With Paved Shoulders of Manu - Simlung Section of NH-44A (86 Kms) In The State of Tripura on EPC Mode.	FROM DES. CH 67+400 - 68+200 PACKAGE-4 VAGHMUN - SIMLUNG SECTION OF NH-44A





MC00 LEVELS	581.786	580.625	579.464	578.303	577.197	576.211	575.346	574.601	573.977	573.473	573.090	572.827	572.685	572.663	572.761	572.980	573.319	573.779	574.359	575.060	575.881	576.823	577.885	579.068	580.316	581.564	582.812	584.060	585.308	586.556	587.805	589.053	590.301	591.549	592.797	594.045	595.294	596.542	597.790	599.038	600.286	
LZ00 LEVELS	580.275	579.127	577.399	576.954	575.402	575.959	575.177	574.289	573.224	568.734	565.327	565.614	564.878	562.802	561.842	561.741	562.201	563.605	565.880	568.126	568.803	566.575	566.947	574.335	577.322	578.388	579.546	580.553	582.375	583.933	585.733	589.191	589.750	600.508	607.463	612.961	602.272	606.309	618.476	615.191	609.790	
Horizontal																																										
Vertical																																										
Superelevation																																										
Chainage	66320,000	663220,000	663240,000	663260,000	663280,000	663300,000	663320,000	663340,000	663360,000	663380,000	664000,000	664200,000	664400,000	664600,000	664800,000	665000,000	665200,000	665400,000	665600,000	665800,000	666000,000	666200,000	666400,000	666600,000	666800,000	667000,000	667200,000	667400,000	667600,000	667800,000	668000,000	668200,000	668400,000	668600,000	668800,000	669000,000	669200,000	669400,000	669600,000	669800,000	669000,000	

Legend	
Building	
Govt. Building	
Shop Gate	
Hut	
Forest pillar	
Water Tank	
Well	
Temple	
TBM.	
Electric Pole	
Telephone Pole	
Ht line 11 & 33 kva	
Nala	
Drain	
Sing Bord	
RYL SP	
Tree Gamla	
Bambu	
Culvert	
Bridge	
Pond	
Handpump	
Transformer	
Traverse Station	
Ground Level	
OFC Welcome Board	
River Canla	
Boundry Wall	
Existing ROW	
Existing BT Center Line	
Existing Road Edge	
Existing Shoulder	
Proposed Center Line	
Proposed CARRIGE WAY	
Proposed Shoulder	
Hms	
Kms RB	
IL BL	
TOWER	
PETROL PUMP	
L T Crossing	
H T Crossing	
Public Tap	

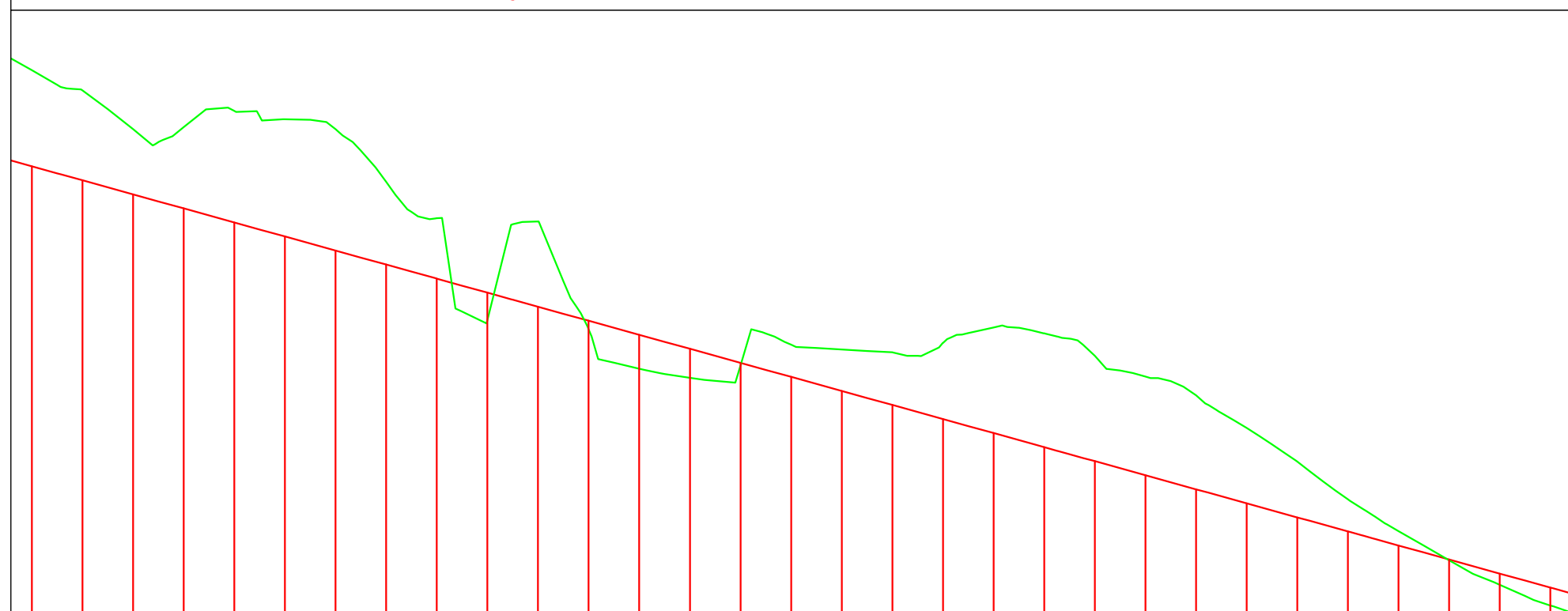
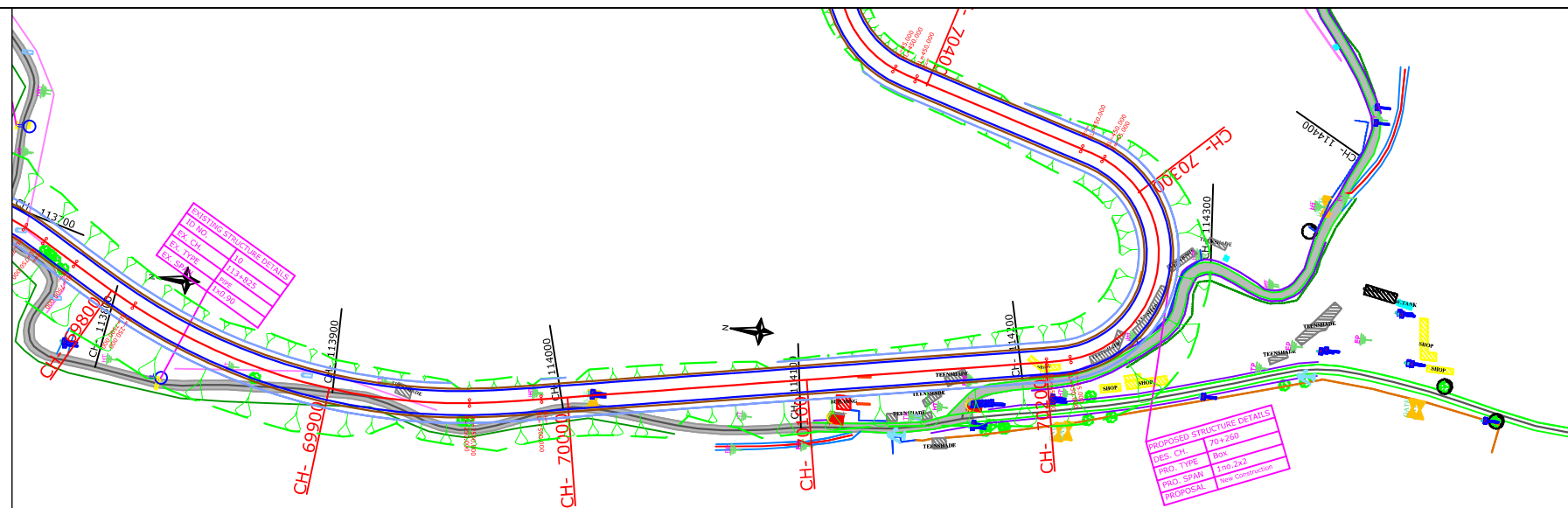

-: CONSULTANTS :-	-: CLIENT :-	DRG. NO. :	DESIGNED BY.	APPROVED BY.	-: PROJECT TITLE :-	-:PLAN & PROFILE:-
M/s Lion Engineering Consultants, Bhopal .  RṛqV P qŦ 9.'ōNlqp'Vqy gtö.'Gngi cpv/Gucvg. Near Mother Teresa School, Kolar Road, Bhopal (M.P.)	NATIONAL HIGHWAYS INFRASTRUCTURE DEVELOPMENT CORPORATION LIMITED (NHIDCL) 	3			Consultancy Services for Preparation of Feasibility Study and Detailed Project Report For Two lane With Paved Shoulders of Manu - Simlung Section of NH-44A (86 Kms) In The State of Tripura on EPC Mode.	FROM DES. CH 68+200 - 69+000 PACKAGE-4 VAGHMUN - SIMLUNG SECTION OF NH-44A

[illegible]

Legend	
Building Govt. Building	 
Shop Gate	
Hut	
Forest pillar	
Water Tank	
Well	
Temple	 
TBM.	
Electric Pole	
Telephone Pole	
Ht line 11& 33 kva	 
Nala	
Drain	
Sing Bord RYL SP	 
Tree Gamla Bambu	 
Culvert	
Bridge	
Pond	
Handpump	
Tranformer	
Traverse Station	
Ground Level	
OFC Welcome Borad	
River Canla	
Boundry Wall	
Existing ROW	
Existing BT Center Line	
Existing Road Edge	
Existing Shoulder	
Proposed Center Line	
Proposed CARRIGE WAY	
Proposed Shoulder	
Hms	 
Kms RB	 
IL BL	 
TOWER PETROL PUMP	 
L T Crossing	
H T Crossing	
Public Tap	

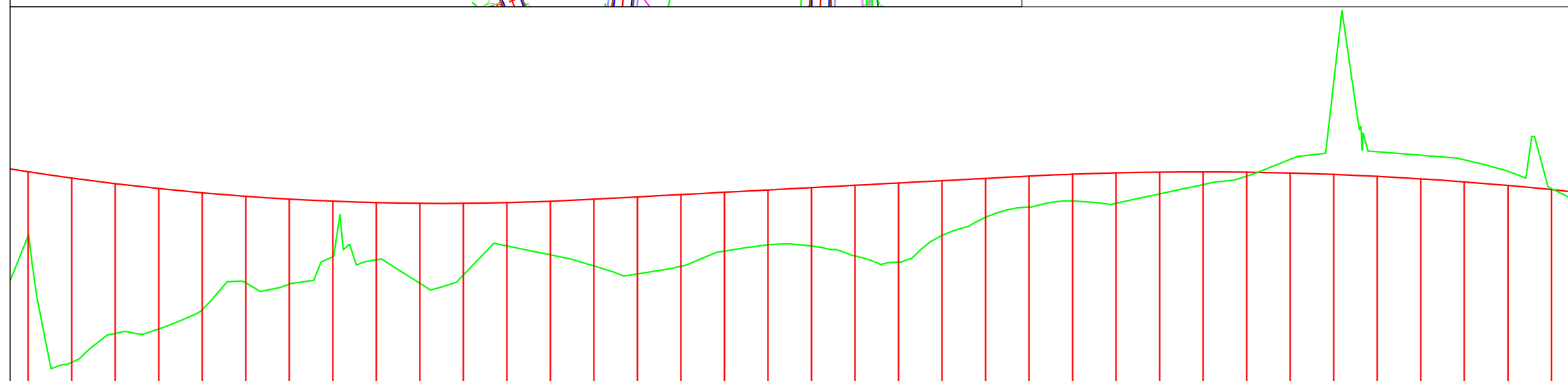
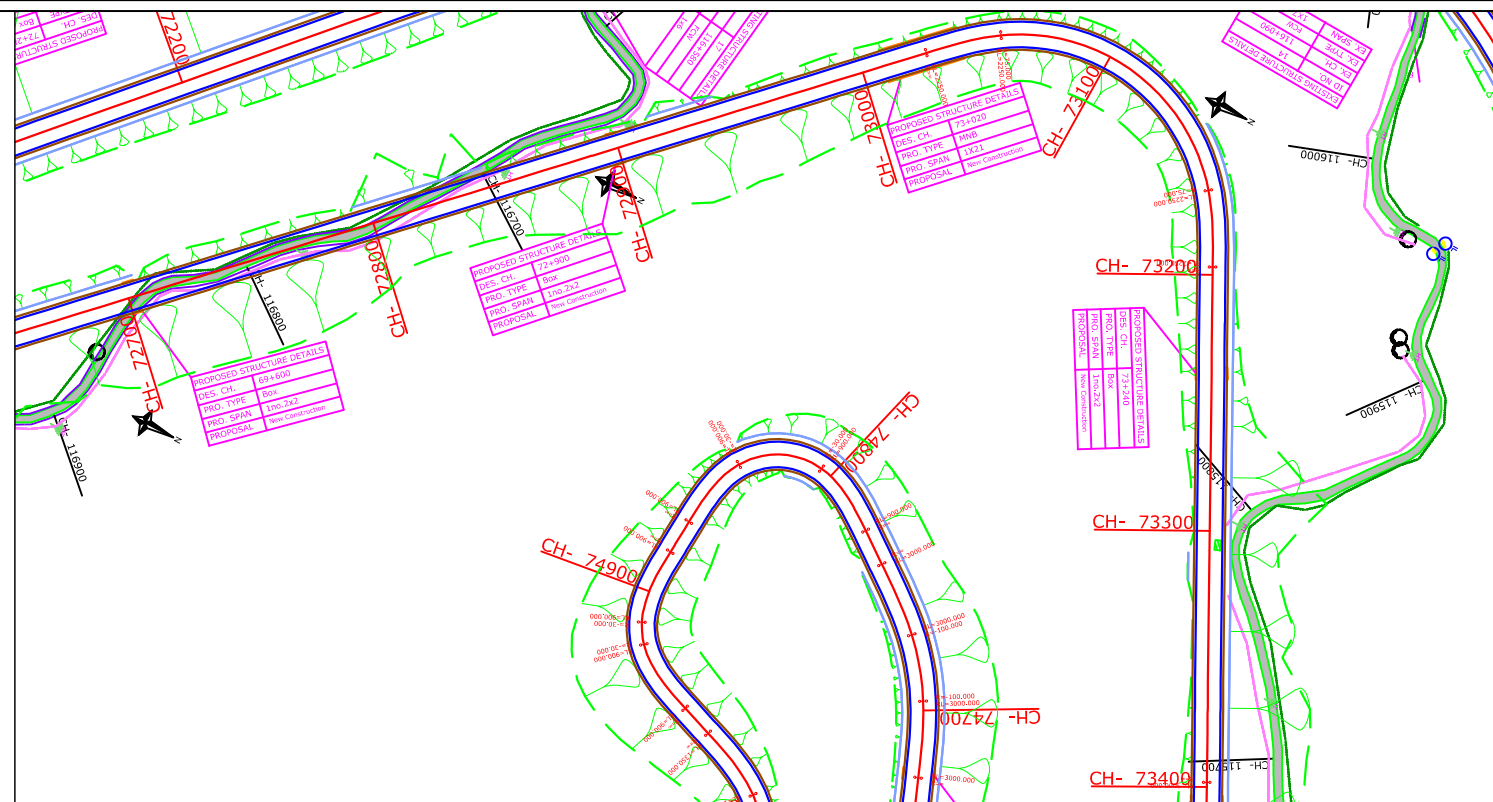
:- CONSULTANTS :-		:- CLIENT :-		DRG. NO. :	DESIGNED BY.	APPROVED BY.	:- PROJECT TITLE :-		:-PLAN & PROFILE:-	
M/s Lion Engineering Consultants, Bhopal .		NATIONAL HIGHWAYS INFRASTRUCTURE DEVELOPMENT CORPORATION LIMITED (NHIDCL)		5			Consultancy Services for Preparation of Feasibility Study and Detailed Project Report For Two lane With Paved Shoulders of Manu - Simlung Section of NH-44A (86 Kms) In The State of Tripura on EPC Mode.		FROM DES. CH 69+800 - 70+400	
 RṛqṽP qḒ 9. "ḡNḡp "Vqy gtḡ. "Ḡḡi cpṽḠucṽg. Near Mother Teresa School, Kolar Road, Bhopal (M.P.)									PACKAGE-4 VAGHMUN - SIMLUNG SECTION OF NH-44A	



:- CONSULTANTS :- M/s Lion Engineering Consultants, Bhopal .  Lion ENGINEERING CONSULTANTS RnqvP q(9."6Nkp"Vqy gtö."Gngi cpvGucvg. Near Mother Teresa School, Kolar Road, Bhopal (M.P.)		:- CLIENT :- NATIONAL HIGHWAYS INFRASTRUCTURE DEVELOPMENT CORPORATION LIMITED (NHIDCL) 		DRG. NO. : <div>10</div>	DESIGNED BY.	APPROVED BY.	:- PROJECT TITLE :- Consultancy Services for Preparation of Feasibility Study and Detailed Project Report For Two lane With Paved Shoulders of Manu - Simlung Section of NH-44A (86 Kms) In The State of Tripura on EPC Mode.	:-PLAN & PROFILE:- FROM DES. CH 72+700 - 73+400 PACKAGE-4 VAGHMUN - SIMLUNG SECTION OF NH-44A
--	--	--	--	-----------------------------	--------------	--------------	---	---

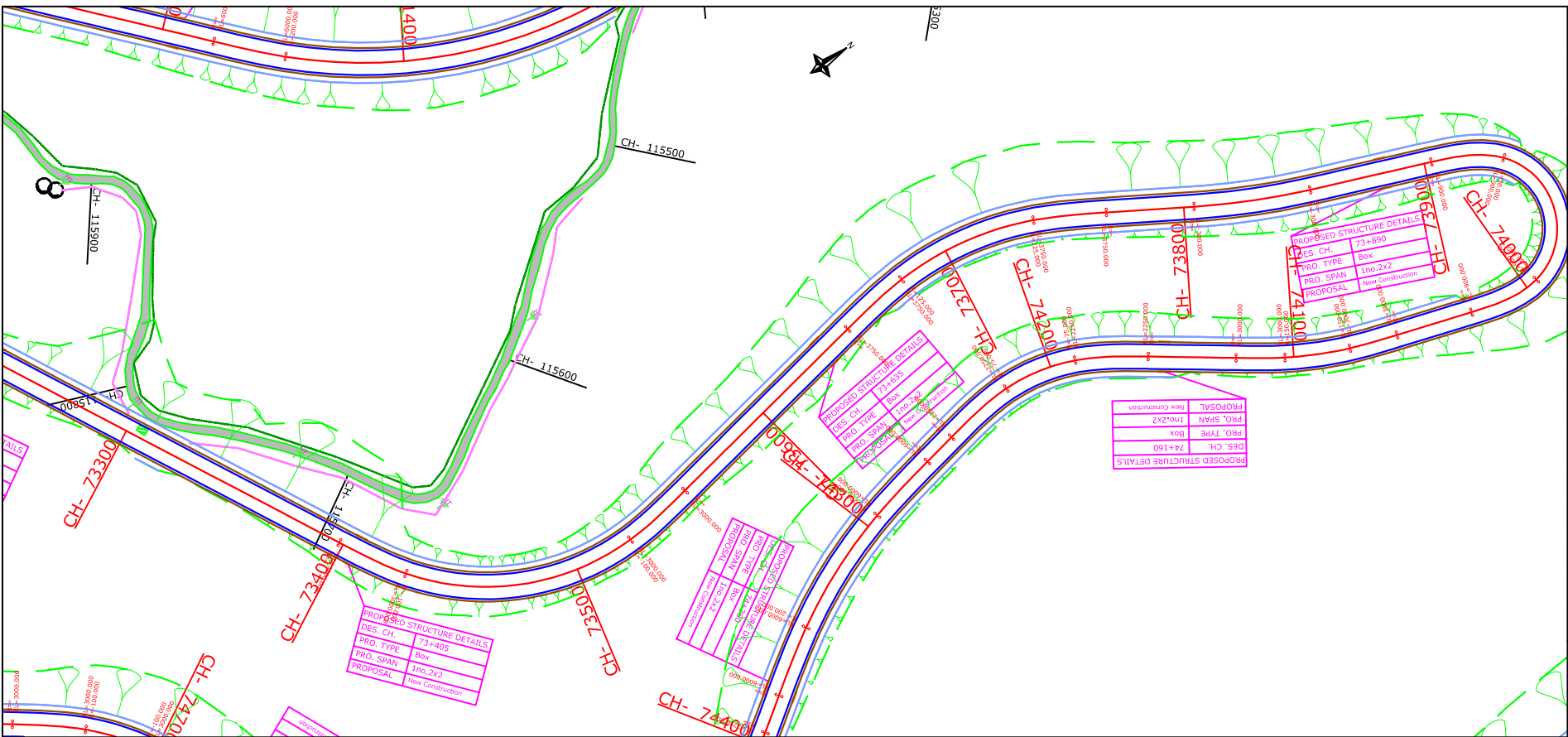

Legend	
Building	
Govt. Building	
Shop Gate	
Hut	
Forest pillar	
Water Tank	
Well	
Temple	
TBM.	
Electric Pole	
Telephone Pole	
Ht line 11& 33 kva	
Nala	
Drain	
Sing Bord RYL SP	
Tree Gamla Bambu	
Culvert	
Bridge	
Pond	
Handpump	
Tranfarmer	
Traverse Station	
Ground Level	
OFC Welcome Borad	
River Canla	
Boundry Wall	
Existing ROW	
Existing BT Center Line	
Existing Road Edge	
Existing Shoulder	
Proposed Center Line	
Proposed CARRIGE WAY	
Proposed Shoulder	
Hms	
Kms RB	
IL BL	
TOWER	
PETROL PUMP	
L T Crossing	
H T Crossing	
Public Tap	

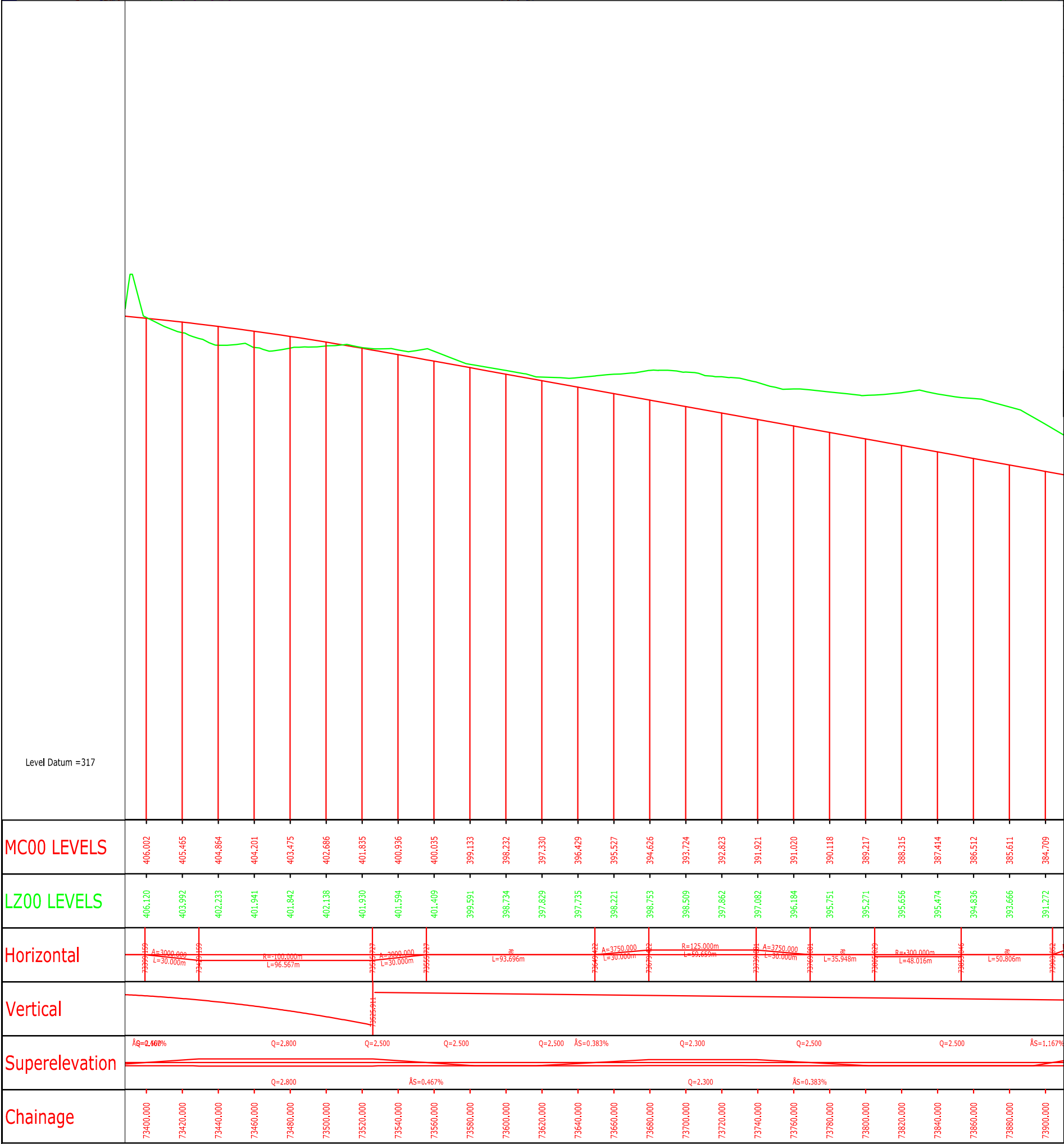

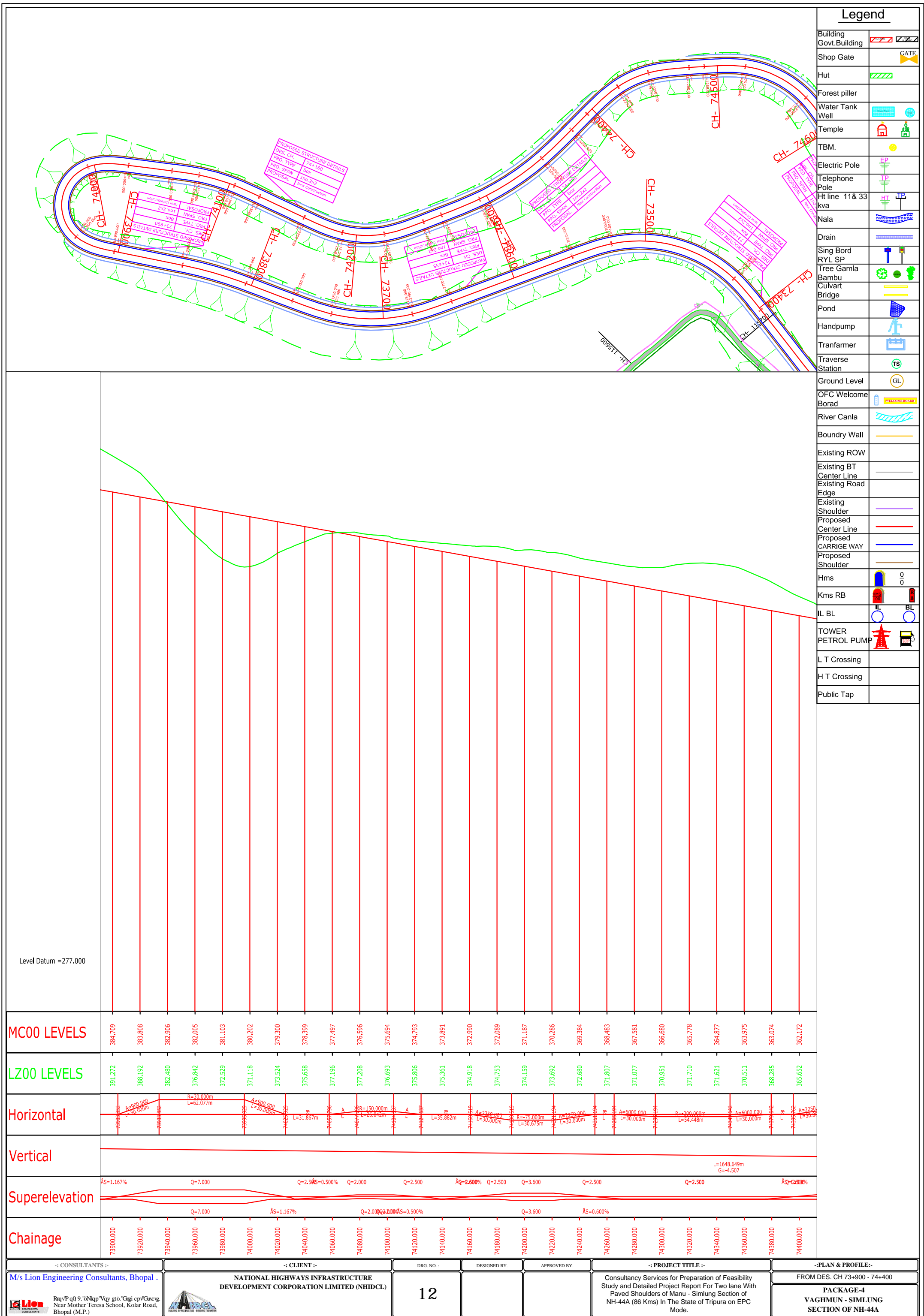

:- CONSULTANTS :-		:- CLIENT :-		DRG. NO. :	DESIGNED BY.	APPROVED BY.	:- PROJECT TITLE :-		:-PLAN & PROFILE:-	
M/s Lion Engineering Consultants, Bhopal .		NATIONAL HIGHWAYS INFRASTRUCTURE DEVELOPMENT CORPORATION LIMITED (NHIDCL)		11			Consultancy Services for Preparation of Feasibility Study and Detailed Project Report For Two lane With Paved Shoulders of Manu - Simlung Section of NH-44A (86 Kms) In The State of Tripura on EPC Mode.		FROM DES. CH 73+400 - 73+900	
									PACKAGE-4 VAGHMUN - SIMLUNG SECTION OF NH-44A	

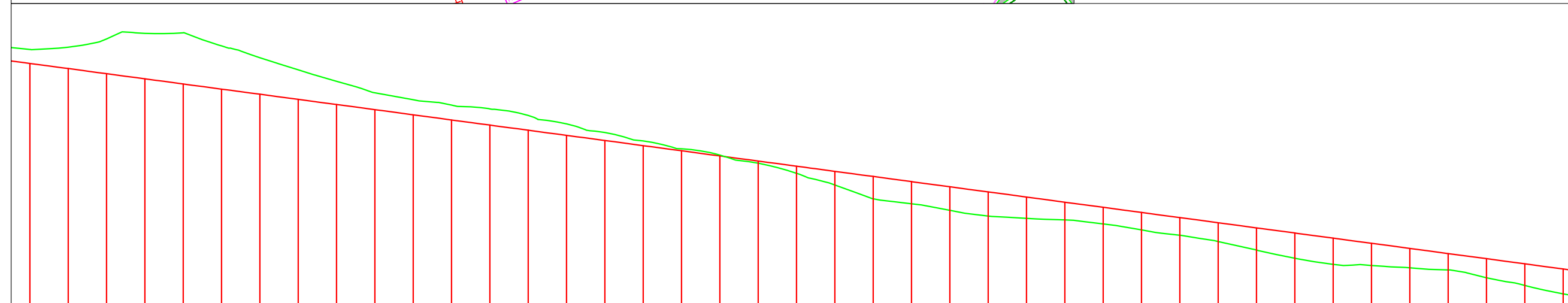
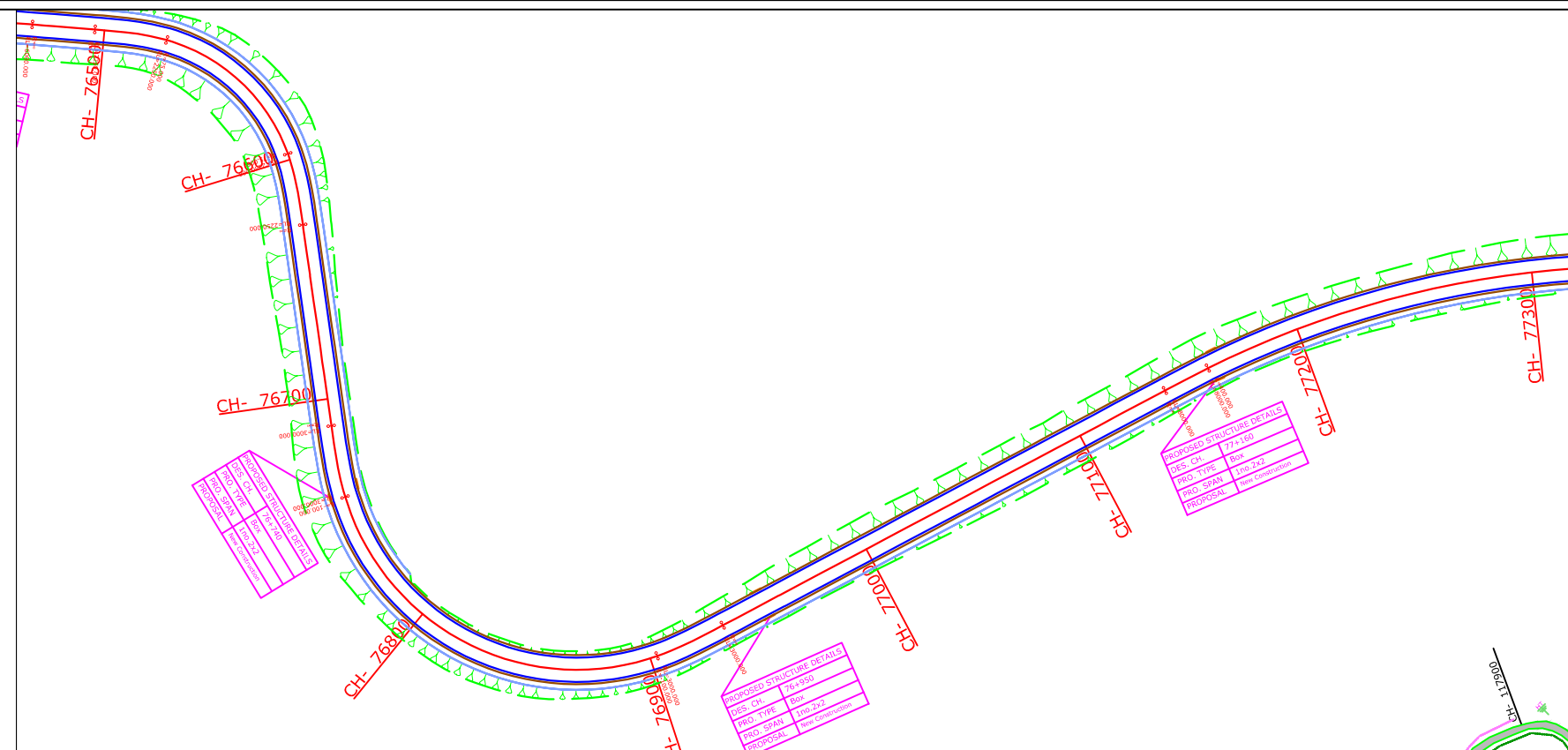



MC00 LEVELS	LZ00 LEVELS	Horizontal	Vertical	Superelevation	Chainage
251.273	255.094				76500.000
252.603	255.388				76520.000
251.933	256.463				76540.000
251.263	257.196				76560.000
250.593	257.271				76580.000
249.923	255.549				76600.000
249.253	254.010				76620.000
248.583	252.436				76640.000
247.913	250.949				76660.000
247.243	249.449				76680.000
246.573	248.538				76700.000
245.903	247.837				76720.000
245.233	247.351				76740.000
244.563	246.482				76760.000
243.893	245.383				76780.000
243.223	244.272				76800.000
242.553	243.169				76820.000
241.883	242.136				76840.000

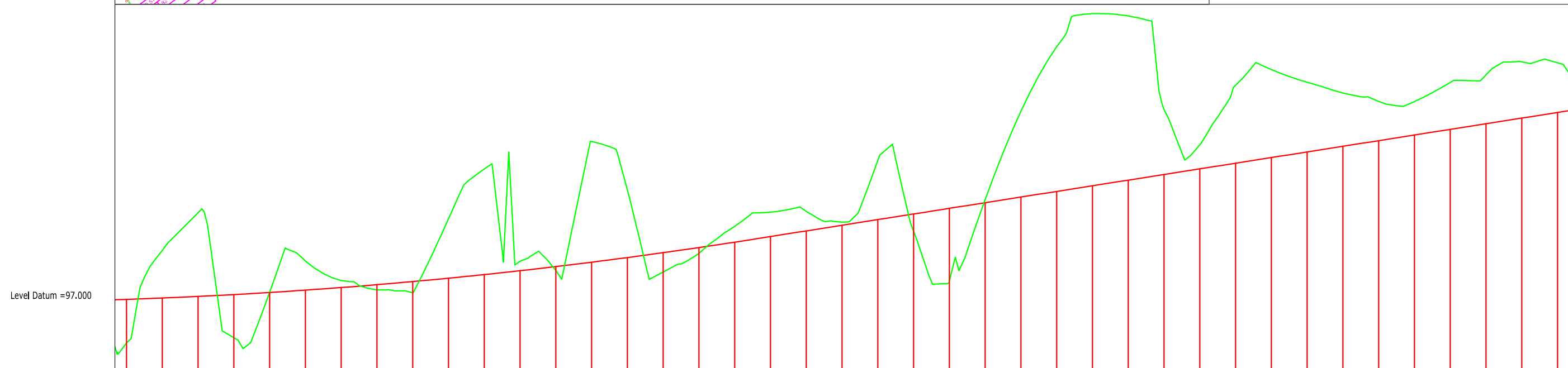
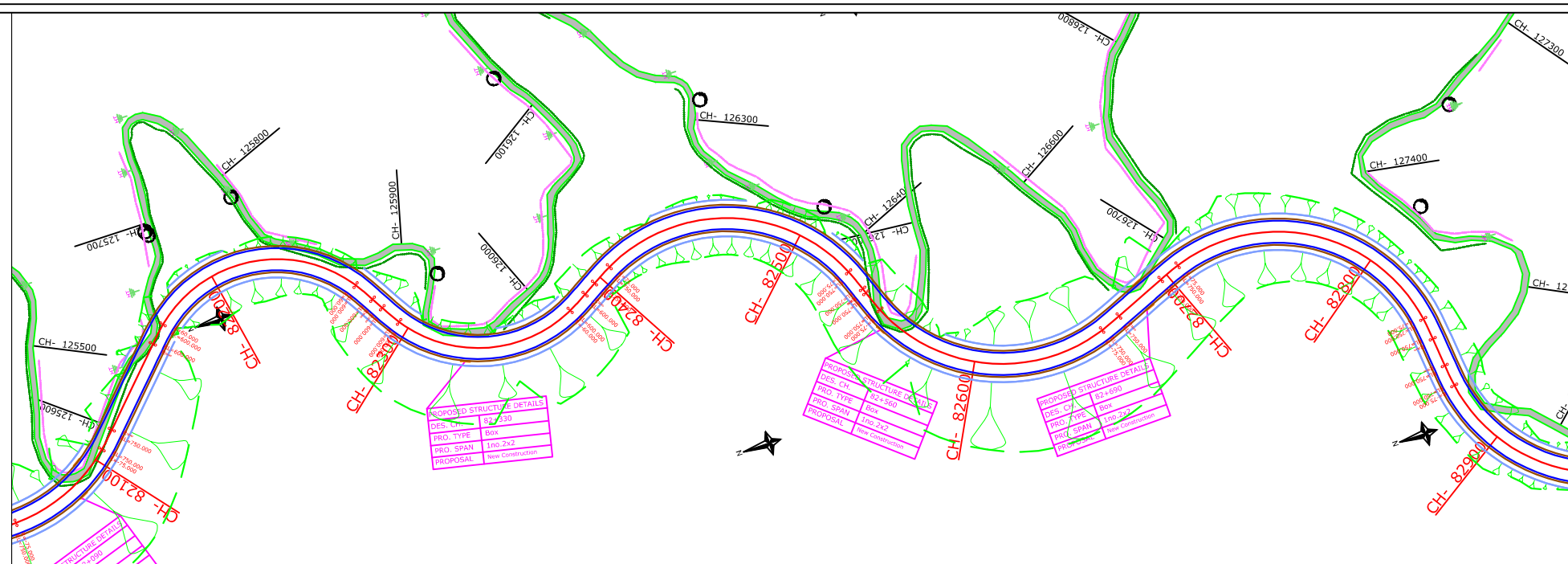

Legend	
Building	
Govt. Building	
Shop Gate	
Hut	
Forest pillar	
Water Tank Well	
Temple	
TBM.	
Electric Pole	
Telephone Pole	
HT line 11& 33 kva	
Nala	
Drain	
Sing Bord RYL SP	
Tree Gamla	
Bambu	
Culvert	
Bridge	
Pond	
Handpump	
Tranformer	
Traverse Station	
Ground Level	
OFC Welcome Borad	
River Canla	
Boundry Wall	
Existing ROW	
Existing BT Center Line	
Existing Road Edge	
Existing Shoulder	
Proposed Center Line	
Proposed CARRIGE WAY	
Proposed Shoulder	
Hms	
Kms RB	
IL BL	
TOWER	
PETROL PUMP	
L T Crossing	
H T Crossing	
Public Tap	

-: CONSULTANTS :-		-: CLIENT :-	DRG. NO. :	DESIGNED BY.	APPROVED BY.	-: PROJECT TITLE :-	-:PLAN & PROFILE:-
M/s Lion Engineering Consultants, Bhopal .  RṛqṽP qŦ 9."ōNkṗ"Vqy gtö."Gngi cpv'Guncg. Near Mother Teresa School, Kolar Road, Bhopal (M.P.)		NATIONAL HIGHWAYS INFRASTRUCTURE DEVELOPMENT CORPORATION LIMITED (NHIDCL) 	16			Consultancy Services for Preparation of Feasibility Study and Detailed Project Report For Two lane With Paved Shoulders of Manu - Simlung Section of NH-44A (86 Kms) In The State of Tripura on EPC Mode.	FROM DES. CH 76+500 - 77+300 PACKAGE-4 VAGHMUN - SIMLUNG SECTION OF NH-44A



MC00 LEVELS	124.817	125.004	125.227	125.485	125.778	126.107	126.471	126.871	127.306	127.777	128.283	128.825	129.402	130.014	130.662	131.345	132.064	132.818	133.603	134.392	135.180	135.969	136.758	137.547	138.336	139.125	139.913	140.702	141.491	142.280	143.069	143.857	144.646	145.435	146.224	147.013	147.801	148.590	149.379	150.168	150.957	
LZ00 LEVELS	118.735	131.662	136.927	119.448	125.794	130.189	127.454	126.143	125.738	136.100	143.056	130.156	128.946	146.895	140.101	128.634	131.263	135.022	137.004	137.112	135.601	144.242	134.323	127.396	138.780	151.129	160.161	164.768	164.449	151.369	146.426	154.755	156.959	155.181	153.681	152.510	152.483	155.142	156.230	158.026	157.894	
Horizontal																																										
Vertical																																										
Superelevation																																										

Legend	
Building	
Govt. Building	
Shop Gate	
Hut	
Forest pillar	
Water Tank	
Well	
Temple	
TBM.	
Electric Pole	
Telephone Pole	
Ht line 11 & 33 kva	
Nala	
Drain	
Sing Bord	
RYL SP	
Tree Gamla	
Bambu	
Culvert	
Bridge	
Pond	
Handpump	
Transformer	
Traverse Station	
Ground Level	
OFC Welcome Borad	
River Canla	
Boundry Wall	
Existing ROW	
Existing BT Center Line	
Existing Road Edge	
Existing Shoulder	
Proposed Center Line	
Proposed CARRIGE WAY	
Proposed Shoulder	
Hms	
Kms RB	
IL BL	
TOWER	
PETROL PUMP	
L T Crossing	
H T Crossing	
Public Tap	

-: CONSULTANTS :-		-: CLIENT :-		DRG. NO. :	DESIGNED BY.	APPROVED BY.	-: PROJECT TITLE :-	-:PLAN & PROFILE:-
M/s Lion Engineering Consultants, Bhopal .  RṛqṽP qŦ 9."ōNkṗ"Vqy gtö."Gngi cpv'Guncvg. Near Mother Teresa School, Kolar Road, Bhopal (M.P.)		NATIONAL HIGHWAYS INFRASTRUCTURE DEVELOPMENT CORPORATION LIMITED (NHIDCL) 		23			Consultancy Services for Preparation of Feasibility Study and Detailed Project Report For Two lane With Paved Shoulders of Manu - Simlung Section of NH-44A (86 Kms) In The State of Tripura on EPC Mode.	FROM DES. CH 82+100 - 82+900 PACKAGE-4 VAGHMUN - SIMLUNG SECTION OF NH-44A

