

DETAIL OF PCC RETAINING WALL

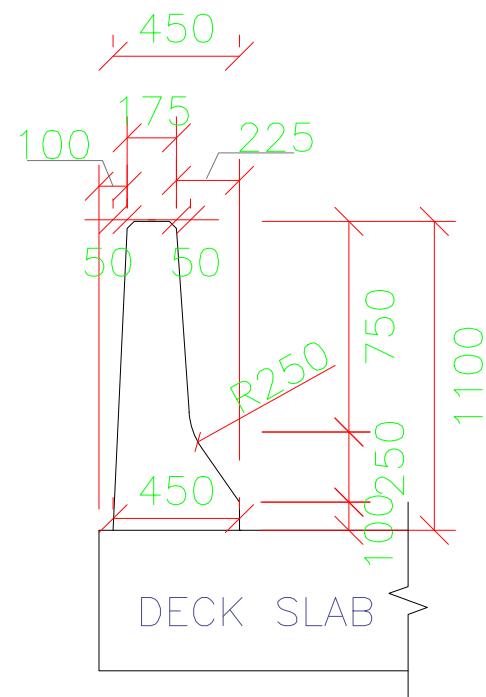

CRASH BARRIER DIMENSIONS

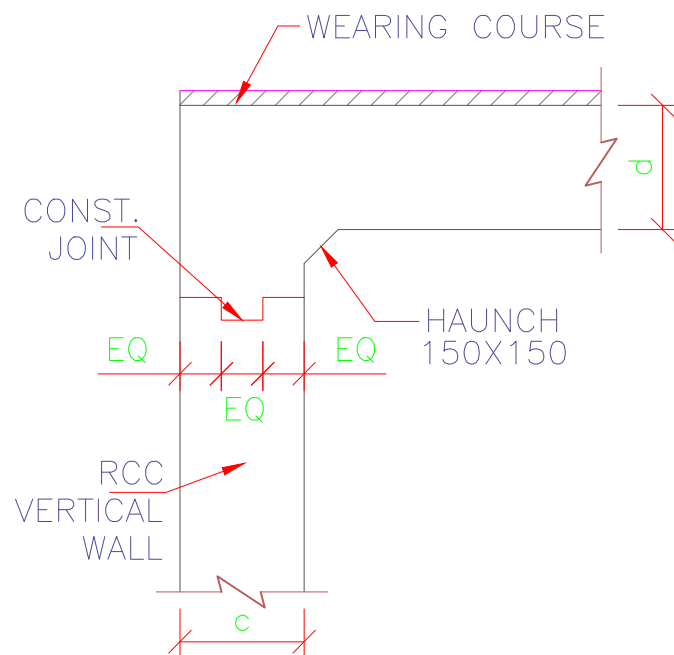

DETAIL-'B'

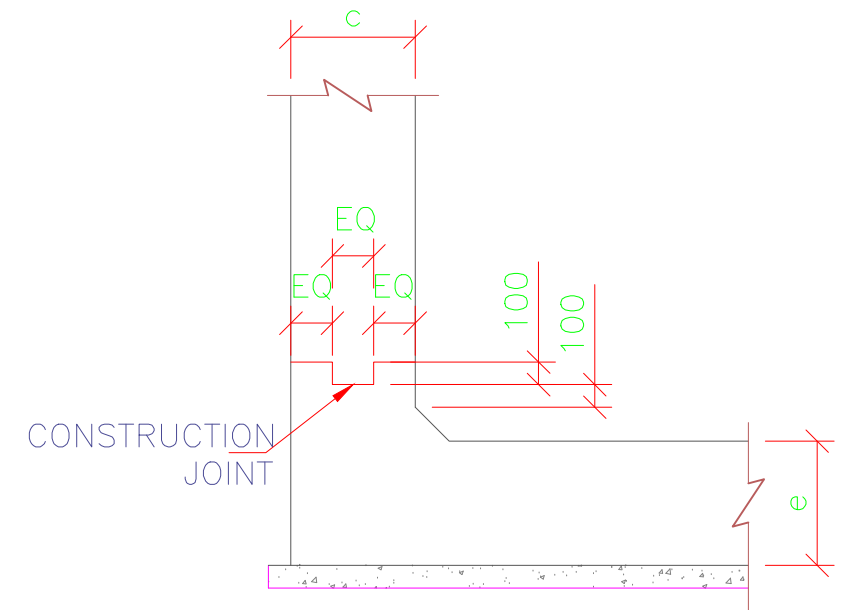

DETAIL-'C'

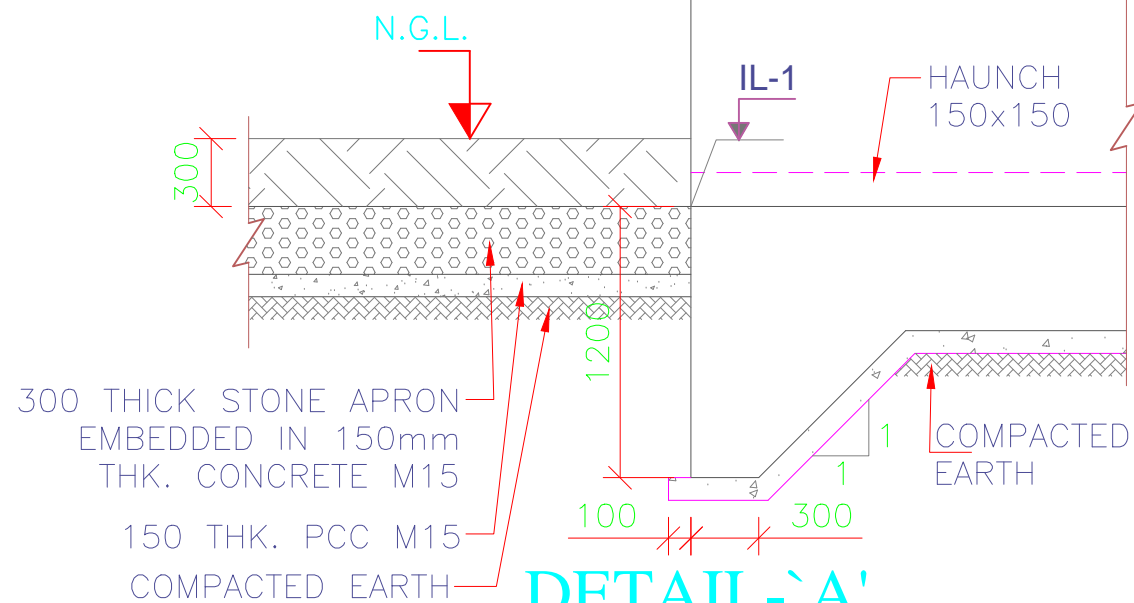

DETAIL-'A'

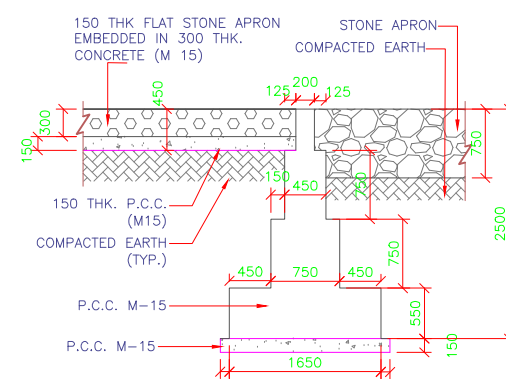

DETAIL OF CURTAIN WALL TYPE-I

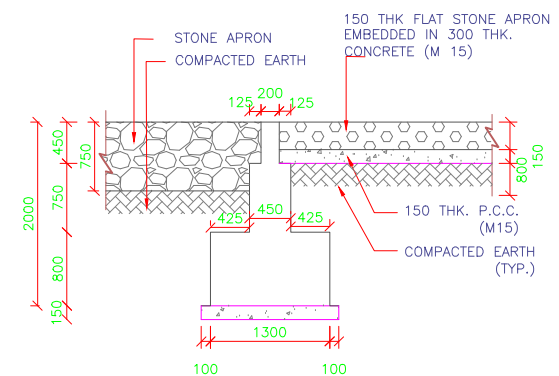

DETAIL OF CURTAIN WALL TYPE-II

:- CONSULTANTS :-

L.N. MALVIYA INFRA PROJECTS PVT. LTD.

T-10, III FLOOR, CITY CENTER, PRESS COMPLEX, PLOT NO.-1,
M.P. NAGAR, ZONE-I, BHOPAL (M.P.)



Tel./Fax : 0755-4295421,
Mob.: 09826452711, 09977004686
E-mail : lninfra@projects@gmail.com

:- CLIENT :-

**NATIONAL HIGHWAYS INFRASTRUCTURE
DEVELOPMENT CORPORATION LIMITED (NHIDCL)**



DRG. NO. :

DESIGNED BY.

APPROVED BY.

:- PROJECT TITLE :-

Consultancy Services for Preparation of Feasibility Study
and Detailed Project Report For Two lane With Paved
Shoulders of Tamenglong - Haflong Road In The State of
Manipur on EPC Mode.

:-General Arrangement Drawing:-

GAD Box- 1X2X2

**PHELONG-AZURAM SECTION
PKG-4**

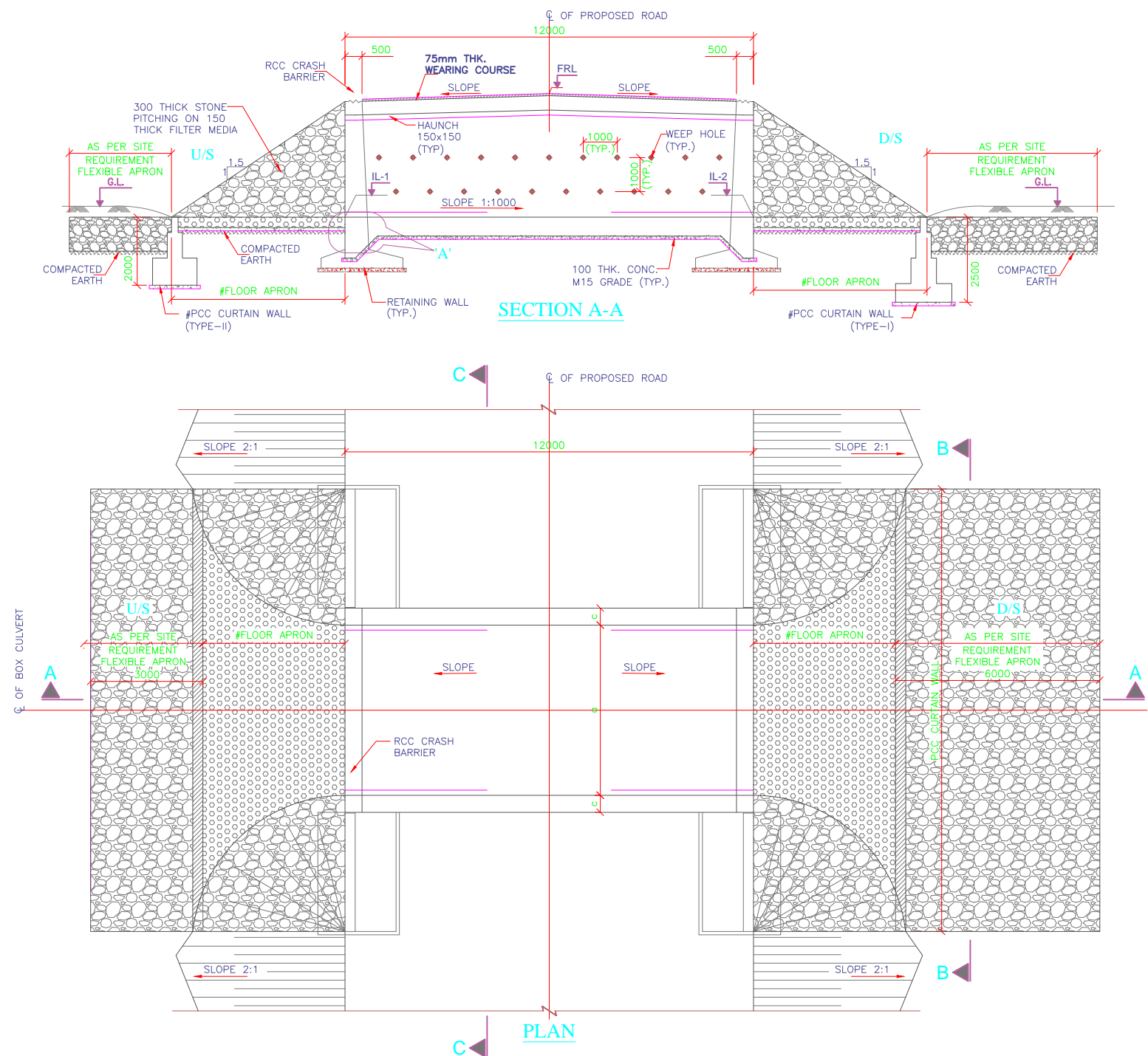

NOTES:-

- ALL DIMENSIONS ARE IN MILLIMETER AND LEVELS ARE IN METER UNLESS MENTIONED OTHERWISE.
- DIMENSIONS ARE NOT TO BE SCALED, ONLY WRITTEN DIMENSIONS SHALL BE FOLLOWED.
- THE SAFE BEARING CAPACITY ASSUMED IN THE DESIGN IS $10T/M^2$. THIS SBC SHOULD BE VERIFIED AT SITE BEFORE EXECUTION. ANY VARIATION ON SITE SHOULD BE INFORMED TO THE DESIGN ENGINEER FOR NECESSARY ACTION.
- GRADE OF UNTENSIONED STEEL SHALL BE Fe 500, CONFIRMING TO IS:1786.
- CONCRETE SHALL BE OF DESIGN MIX AND SHALL HAVE MINIMUM 28 DAYS CHARACTERISTIC CUBE STRENGTH AS FOLLOWS:-
 - RCC BOX..... M25
 - RCC CRASH BARRIER..... M40
 - RETAINING WALL..... M30
 - PCC LEVELING COURSE.... M15
- THE RCC BOX SHOULD BE CONSTRUCTED FIRST AND THE SIDE FILLING & COMPACTION SHALL BE DONE AS PER MoRTH SPECIFICATIONS.
- THE BACKFILL MATERIAL BEHIND RCC BOX/RETAINING WALL SHALL HAVE FOLLOWING PROPERTIES $\phi=30^\circ, \gamma=2.0 T/Cum$
- DETAIL OF CAMBER/SUPER ELEVATION MAY BE VERIFIED WITH LATEST PLAN AND PROFILE DRAWING.
- FLOW DIRECTION SHOWN IN THE DRAWING IS INDICATIVE ONLY. BED PROTECTION FOR UPSTREAM AND DOWN STREAM SHALL BE BASED ON THE FLOW DIRECTION IN SITE.
- FLEXIBLE APRON SHALL BE PROVIDED AS PER THE SPECIFICATION/DETAILS MENTIONED IN PLATE-22 OF IRC:SP:13-2004.
- DISCREPANCY IF ANY IS TO BE IMMEDIATELY BROUGHT IN TO THE NOTICE OF ENGINEER FOR NECESSARY MODIFICATION IN THE DRAWING.
- 100mm ϕ PVC WEEP HOLES SPACED AT 1000c/c BOTH HORIZONTALLY AND VERTICALLY SHALL BE PROVIDED IN RETAINING WALL.
- 600mm THK. FILTER MEDIA SHALL BE PROVIDED BEHIND RETAINING WALL.
- ALL LEVELS SHOWN IN THIS DRAWING SHOULD BE VERIFIED AT SITE WITH RESPECT TO PLAN & PROFILE BEFORE EXECUTION OF WORK.

LEGEND:-

FRL	-	FINISHED ROAD LEVEL
GL.	-	GROUND LEVEL
LVL.	-	LEVEL
IL	-	INVERT LEVEL

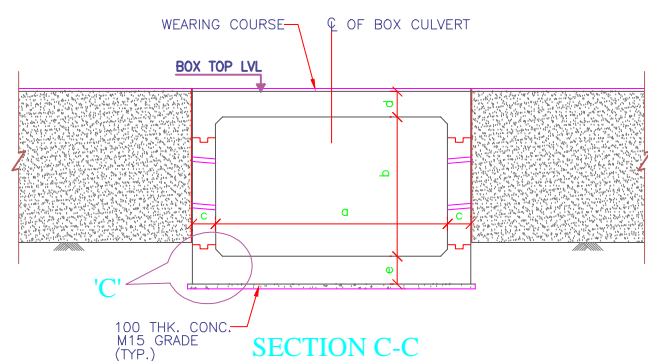
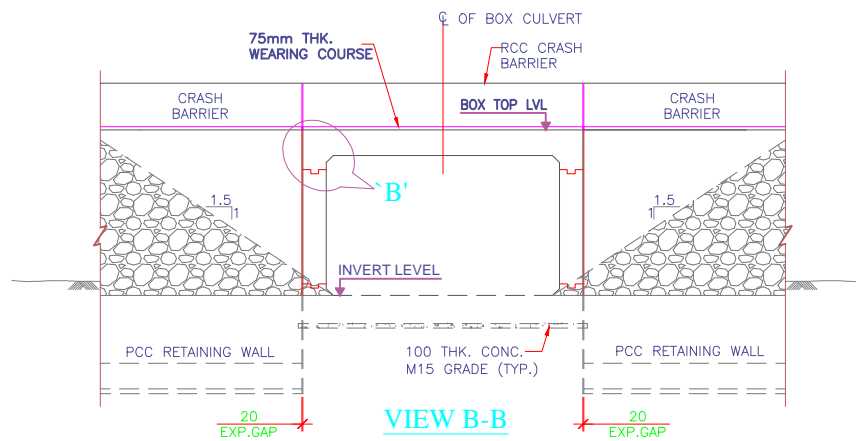

TABLE-1 SCHEDULE OF BOX CULVERT

S. No.	DESIGN CH: SCHEDULE	PROPOSAL	DIRECTION OF FLOW	SKEW ANGLE	PROPOSED DETAILS					
					TYPE	DIMENSION DETAILS OF BOX				
1		NEW CONSTRUCTION	R TO L	0°	BOX	3000	3000	420	420	420

TABLE-2 DIMENSION DETAILS OF PCC RETURN WALL

S. No.	DIMENSION DETAILS(mm)					
	R0	R1	R2	RH	RH1	RH2
1	4450	500	3950	5170	600	4570

:- CONSULTANTS :-

L.N. MALVIYA INFRA PROJECTS PVT. LTD.

T-10, III FLOOR, CITY CENTER, PRESS COMPLEX, PLOT NO.-1,
M.P. NAGAR, ZONE-I, BHOPAL (M.P.)



Tel./Fax : 0755-4295421,
Mob.: 09826452711, 099777004686
E-mail : lninfraprojects@gmail.com

:- CLIENT :-

**NATIONAL HIGHWAYS INFRASTRUCTURE
DEVELOPMENT CORPORATION LIMITED (NHIDCL)**



DRG. NO. :

DESIGNED BY.

APPROVED BY.

:- PROJECT TITLE :-

Consultancy Services for Preparation of Feasibility Study and Detailed Project Report For Two lane With Paved Shoulders of Tamenglong - Haflong Road In The State of Manipur on EPC Mode.

:-General Arrangement Drawing:-

BOX CULVERT Span-1No. 3X3

**PHELONG-AZURAM SECTION
PKG-4**

